



PROGRAMA CIENTÍFICO

06 A 08 FEVEREIRO 2019

FACULDADE DE FARMÁCIA U. PORTO

XLIX REUNIÃO SOCIEDADE PORTUGUESA DE FARMACOLOGIA

XXXVII REUNIÃO FARMACOLOGIA CLÍNICA

XVIII REUNIÃO TOXICOLOGIA

VENUE MAP - FACULTY OF PHARMACY UNIVERSITY OF PORTO

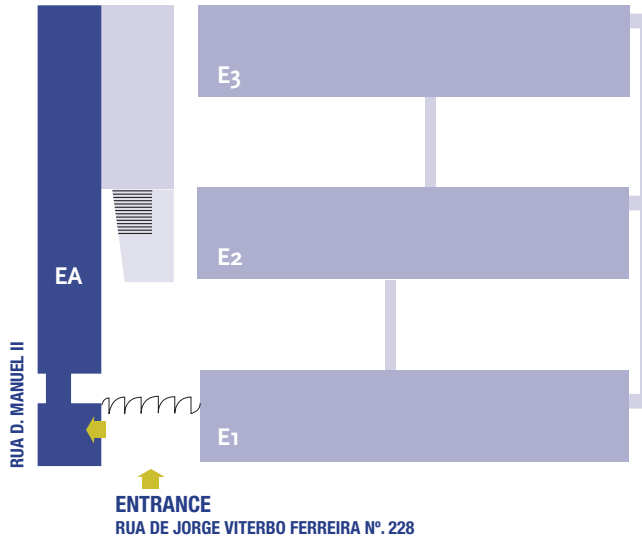

BUILDING EA

4TH FLOOR - GREAT HALL - Salão Nobre ICBAS/FFUP

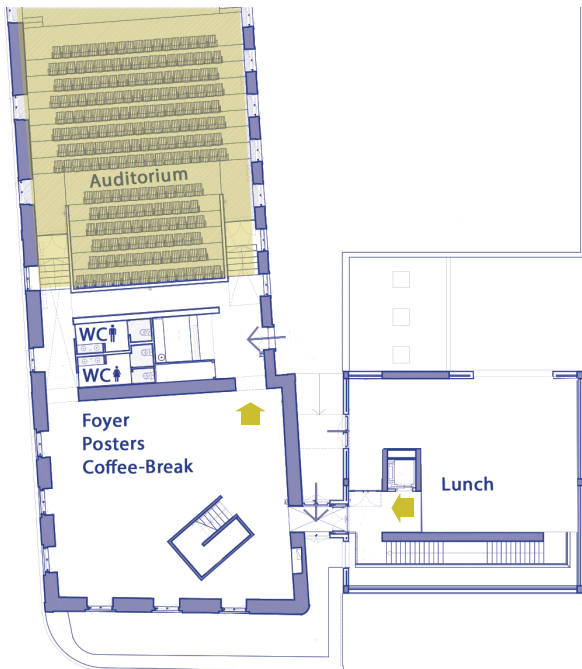

1ST FLOOR - Anfiteatro 8

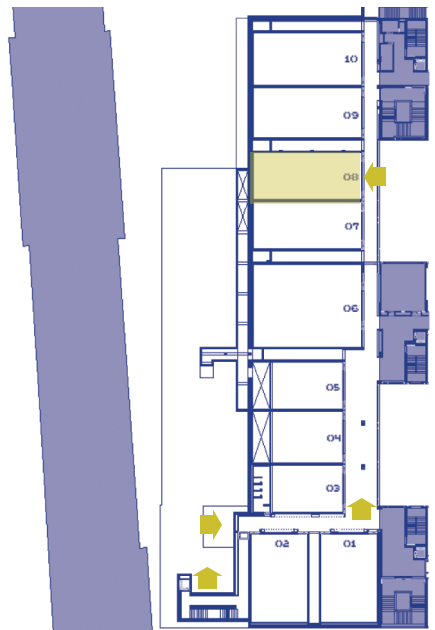

Salão Nobre ICBAS/FFUP **OPENING SESSION**

09:15 JOSÉ MANUEL SOUSA LOBO (Diretor da FFUP)
CLÁUDIA CAVADAS (Presidente SPF)
GLÓRIA QUEIROZ E FÉLIX CARVALHO (Organização SPF 2019)

10:00 **Coffee Break**

10:15 **FREE ORAL COMMUNICATIONS**

Salão Nobre ICBAS/FFUP

CHAIRS: Paula Canas and Jorge Oliveira

SESSION 1 NEUROPHARMACOLOGY I

Amfiteatro 8

CHAIRS: Paula Guedes de Pinho and Vera Marisa Costa

SESSION 2 TOXICOLOGY I

10:15 **1.1 ADRENALINE APPEARS TO CONTRIBUTE FOR THE PERSISTENCE OF TRAUMATIC MEMORIES IN POST-TRAUMATIC STRESS DISORDER BY INFLUENCING NR4A GENES EXPRESSION IN HIPPOCAMPUS**
Raquel Martinho, Ana Oliveira, Gabriela Correia, Márcia Marques, Paula Serrão, Mónica Moreira-Rodrigues

2.1 EFFECTS OF DOXORUBICIN AND MITOXANTRONE IN BRAIN GLUTATHIONE OF DIFFERENT AGED MICE: AN IN VIVO STUDY
Ana Carvalho, Ana Reis-Mendes, Margarida Duarte-Araújo, Rita Guedes, Salomé Monteiro, Félix Carvalho, Maria Lourdes Bastos, João Paulo Capela, Vera Marisa Costa

10:30 **1.2 ESCLICARBAZEPINE ACETATE IS ANTI-TREMORGENIC IN A MOUSE MODEL OF ESSENTIAL TREMOR**
N. Pires, A. Coelho, M.J. Bonifácio, P. Soares-da-Silva

2.2 METABOLOMICS APPROACH IN THE INVESTIGATION OF HEPATIC METABOLIC CHANGES CAUSED BY MDMA
Ana Margarida Araújo, Maria de Lourdes Bastos, Eduarda Fernandes, Félix Carvalho, Márcia Carvalho, Paula Guedes de Pinho

10:45 **1.3 STRESS COPING IN ADULTHOOD IN A MODEL OF PRENATAL STRESS: GENDER DIFFERENCES**
Rita Gaspar, Carina Soares-Cunha, Bárbara Coimbra, Ana Verónica Domingues, Filipa Baptista, Carlos A. Fontes-Ribeiro, Nuno Sousa, António F. Ambrósio, Ana João Rodrigues, Catarina A. Gomes

2.3 METHOD IMPLEMENTATION AND VALIDATION TO SCREEN GLUTATHIONE-TRAPPED REACTIVE METABOLITES USING A HIGH-RESOLUTION MASS SPECTROMETER
Telma Bernardo, Joana Rebouta, C. Fernandes-Lopes, P. Soares-da-Silva, Ana I. Loureiro

11:00 **1.4 ADENOSINE A_{2A} RECEPTORS IN THE RAT PRELIMBIC MEDIAL PREFRONTAL CORTEX CONTROL DELAY-BASED COST-BENEFIT DECISION MAKING**
Douglas T. Leffa, Pablo Pandolfo, Nélio Gonçalves, Nuno J. Machado, Carolina M. de Souza, Joana I. Real, António C. Silva, Henrique B. Silva, Attilia Kófalvi, Rodrigo A. Cunha, Samira G. Ferreira

2.4 MITOCHONDRIAL IMPAIRMENT AND OXIDATIVE STRESS INDUCED BY SYNTHETIC CATHINONES ON DOPAMINERGIC SH-SY5Y CELLS
Jorge Soares, Vera Marisa Costa, Helena Gaspar, Susana Santos, Maria Lourdes Bastos, Félix Carvalho, João Paulo Capela

11:15 **1.5 TARGETING A_{2A}R TO MANAGE MOTOR AND COORDINATION DEFICITS FOUND IN ANGELMAN SYNDROME MICE MODEL**
Ana Moreira de Sá, Francisco Queiroz, João P. Lopes, Henrique B. Silva, Ângelo R. Tomé, Rodrigo A. Cunha, Paula M. Canas

2.5 SUB-CHRONIC EXPOSURE TO THERAPEUTIC DOSES OF TRAMADOL AND TAPENTADOL CAUSES NEUROTOXICITY IN WISTAR RATS
Juliana Faria, Joana Barbosa, Sandra Leal, Vanessa Nascimento, Luís Pedro Afonso, Frederico Pereira, Félix Carvalho, Ricardo Jorge Dinis-Oliveira

11:30 **1.6 NEURODEVELOPMENTAL ASSESSMENT IN RATS PRENATALLY EXPOSED TO GLUCOCORTICOIDS MAY ANTICIPATE CHRONIC ANXIETY STATES LATER IN LIFE**
Sofia Galvão, Ana S. Ferreira, Inês Ventura, Rita Gaspar, Ana C. Rodrigues-Neves, Carlos A. Fontes-Ribeiro, António F. Ambrósio, Filipa Baptista, Catarina A. Gomes

2.6 IN VITRO TOXICITY OF CERAMIC NANOPARTICLES IN HUMAN ALVEOLAR CELLS AT SUBMERGED AND AIR-LIQUID CELL CULTURE CONDITIONS
Maria João Bessa, Sónia Fraga, Fátima Brandão, Paul Fokkens, John Boere, Daan Leseman³, Apostolos Salmattonidis, Mar Viana, Flemming Cassee³, João Paulo Teixeira

11:45 **1.7 SUPEROXIDE GENERATED IN MITOCHONDRIA EVOKES PARKINSONIAN PHENOTYPES IN ZEBRAFISH AND HUNTINGTIN AGGREGATION IN CELLS**
Brígida R. Pinho, Sara D. Reis, Richard Hartley, Michael Murphy, Jorge M. A. Oliveira

2.7 CYTOTOXICITY AND GENOTOXICITY OF DIFFERENT CLASSES OF MANUFACTURED NANOMATERIALS IN RAT ALVEOLAR EPITHELIAL CELLS
Fátima Brandão, Sónia Fraga, Carla Costa, Susana Silva, Maria João Bessa, Andrea Haase, João Paulo Teixeira

12:00 **1.8 IMPACT OF ASTROCYTES ON SYNAPTIC PLASTICITY IN ALZHEIMER'S DISEASE CONDITIONS**
Cátia Lopes, Marlene C. Pereira, Inês Amaral, Marlene Domingues, Paula M. Canas, Rodrigo A. Cunha, Paula Agostinho

2.8 THE SIZE AND COATING OF SILVER NANOPARTICLES DIFFERENTLY AFFECTS IN VITRO HUMAN NEUTROPHILS' OXIDATIVE BURST, CALCIUM LEVELS AND VIABILITY
Tânia Soares, Félix Carvalho, Eduarda Fernandes, Marisa Freitas

12:15 **Lunch** (for registered participants only)

Salão Nobre ICBAS/FFUPCHAIRS: *Sara Xapelli and Luis P. Almeida***SESSION 3 MOLECULAR & CELLULAR BASED THERAPIES I****3.1 EXTRACELLULAR VESICLES-ASSOCIATED AAVS AS GENE DELIVERY VECTORS FOR THE TREATMENT OF BRAIN DISEASES***Carina Henriques, Miguel Lopes, Patricia Albuquerque, David Rufino-Ramos, Laetitia Gaspar, Diana Lobo, Sónia Duarte, Magda Santana, Rui Jorge Nobre, Luis Pereira de Almeida***3.2 ADENOSINE A_{2A} RECEPTOR ACTIVATION PROMOTES FIBROSIS BY FAVORING PANNEXIN-1 OVEREXPRESSION IN HUMAN SUBCUTANEOUS FIBROBLASTS***Carina Herman-de-Sousa, A.R. Pinheiro, D. Paramos-de-Carvalho, M.A. Costa, M.T. Magalhães-Cardoso, Fátima Ferreira, S. Ribeiro, P. Correia-de-Sá***3.3 CHARACTERIZATION OF ANIMAL BEHAVIOUR AND ADULT OLIGODENDROGENESIS IN A MOUSE MODEL OF MULTIPLE SCLEROSIS***Joana Moura Mateus, Rita Soares, Marta Alonso Gomes, Sara L Paulo, Ângelo F Chora, Ana M Sebastião, Sara Xapelli***3.4 ROLE OF ADENOSINE A_{2A} RECEPTORS IN ADULT OLIGODENDROGENESIS USING A MOUSE MODEL OF MULTIPLE SCLEROSIS***Marta Alonso Gomes, Joana Moura Mateus, Ana M Sebastião, Sara Xapelli***3.5 OVEREXPRESSION OF ADP-SENSITIVE P2Y₁₂ AND P2Y₁₃ RECEPTORS DOWNREGULATES THE P2Y₁-INDUCED OSTEOGENESIS OF BONE MARROW MESENCHYMAL STEM CELLS IN POSTMENOPAUSAL WOMEN***Catarina Andrés, Rui Cardoso, Maria Adelina Costa, José Marinhas, Rolando Freitas, José Bernardo Noronha-Matos, Paulo Correia-de-Sá***3.6 HUMAN IPSC-DERIVED NEUROEPITHELIAL STEM CELLS FOR NEUROPROTECTION AND NEUROREGENERATION IN MACHADO-JOSEPH DISEASE***Liliana S. Mendonça, Daniel Henriques, Ricardo Moreira, Sónia Duarte, Jens C. Schwamborn, Luis Pereira de Almeida***3.7 EXOSOMES AS A DELIVERY SYSTEM FOR MIRNAS IN MACHADO-JOSEPH DISEASE***David Rufino-Ramos, Vítor Carmona, Inês M. Martins, Patricia R. Albuquerque, Rita Perfeito, Rui Jorge Nobre, Luis Pereira de Almeida***3.8 EFFECT OF DIFFERENT GMP SERUM-FREE MEDIA IN THE PLASTICITY OF DENDRITIC CELLS FOR CLINICAL USE IN CANCER IMMUNOTHERAPY: FUNCTIONAL AND METABOLIC CHARACTERIZATION***João Calmeiro, Myléne Carrascal, Célia Gomes, Amílcar Falcão, João Serra, Maria Teresa Cruz, Bruno Neves***Anfiteatro 8**CHAIRS: *Carmen Diniz and Carlos F. Ribeiro***SESSION 4 CARDIOVASCULAR PHARMACOLOGY****4.1 CIRCULATING ENDOTHELIAL PROGENITOR CELLS AND CLINICAL EVOLUTION OF HEART FAILURE PATIENTS SUBMITTED TO CARDIAC RESYNCHRONIZATION THERAPY***Gonçalo Cristóvão; James Milner, Pedro Sousa, Miguel Ventura, João Cristóvão, Luis Elvas, Artur Paiva, Lino Gonçalves, Carlos Fontes Ribeiro, Natália Antónimo***4.2 PHARMACOLOGICAL BLOCKING OF AHR REDUCES HYPERTENSION INDUCED BY CHRONIC INTERMITTENT HYPOXIA***Nuno R. Coelho, Maria J. Correia, Céline Tomkiewicz, Clara G. Dias, Robert Barouki, Sofia A. Pereira, Xavier Coumoul, Emília C. Monteiro***4.3 ENDOTHELIAL DYSFUNCTION AND INFLAMMATION RESOLVING MEDIATORS IN HUMAN ACUTE HEART FAILURE***Marta Reina-Couto, João Pedro Bessa, Marisa Oliveira-Santos, Paula Serrão, Joana Afonso, Roberto Roncon-Albuquerque, José Artur Paiva, António Albino-Teixeira, Teresa Sousa***4.4 HYDROXYTYROSOL PREVENTS INCREASE IN SYSTOLIC BLOOD PRESSURE INDUCED BY CHRONIC INTERMITTENT HYPOXIA***M. João Correia, Nuno R. Coelho, Elsa Mecha, Clara Gonçalves-Dias, Sandra Silva, Teresa Serra, Maria R. Bronze, Emília C. Monteiro, Sofia A. Pereira***4.5 INVOLVEMENT OF P2 PURINOCEPTORS IN THE CONTROL OF SINOATRIAL NODE ACTIVITY***Bruno Bragança, Sílvia Nogueira-Marques, Ana Patrícia Fontes-Sousa, Paulo Correia-de-Sá***4.6 MESENTERIC ARTERY HYPERSYMPATHETIC ACTIVATION IN AN ANIMAL MODEL OF FETAL PROGRAMMING OF HYPERTENSION***Maria Sofia Rocha, Joana Sousa, Pilar Rodriguez-Rodriguez, Angel Luis López de Pablo, Maria del Carmen Gonzalez, Sílvia Arribas, Carmen Diniz***4.7 VASCULAR EFFECTS OF EXTRACTS FROM AGRIMONIA EUPATORIA, FRAGARIA VESCA AND URTICA DIOICA***J. Malheiros, D. Fonseca, D. Simões, P. Antunes, A. Figueirinha, D. Cotrim***4.8 ADENOSINE RECEPTORS IN MESENTERIC ARTERIES ADVENTITIA: EVIDENCE FOR A NUCLEAR LOCATION***Rita Ribeiro Oliveira, Martin Vojtek, Salomé Monteiro, Joana Beatriz Sousa, Camen Diniz***4.9 VASCULAR EFFECTS AND ANTIOXIDANT ACTIVITY OF CYMBOGOPON CITRATUS***D. Simões, D.A. Fonseca, J. Malheiros, P. E. Antunes, A. Figueirinha, M. D. Cotrim*

Salão Nobre ICBAS/FFUP

CHAIR: Jorge Gonçalves

16:00

INVITED LECTURE

DRUG REPURPOSING IN ONCOLOGY - AN OVERVIEW, SPEAKER: PAN PANTZIARKA

17:00

FREE ORAL COMMUNICATIONS

Salão Nobre ICBAS/FFUP

CHAIRS: Fátima Martel and Paula Fresco

SESSION 5 CANCER PHARMACOLOGY I

5.1 OVEREXPRESSION OF THE GOLGI ION CHANNEL HGAAP INCREASES SURVIVAL OF OSTEOSARCOMA CELLS
Nuno Almeida, Marta Martins, João Teodoro, Carlos Palmeira, Geoffrey L. Smith, Ana Fernandes, Nuno Saraiva

17:00

5.2 TARGETING NEUROBLASTOMA WITH A NEW TAP73 ACTIVATOR
Madalena N. Monteiro, Sara Gomes, Liliana Raimundo, Joana Soares, Joana B. Loureiro, Mariana Leão, Helena Ramos, Madalena Pinto, Petr Chlapek, Renata Veselska, Emília Sousa, Lucília Saraiva

17:15

5.3 METFORMIN SYNERGIZES 5-FLUOROURACIL CHEMOTHERAPEUTIC EFFECT BY MODULATING THE REDOX STATUS
B. Allal, A. Bounaama, I. Abdelaziz, J. Gonçalves, S. Velho, P. Fresco, B. Djerdjour

17:30

5.4 ANTICANCER ACTIVITY OF THYMOQUINONE IN HUMAN RENAL CANCER CELLS
João G. Costa, Vanessa Kesper, Constance Jackson, Nuno Saraiva, Nuno Almeida, Sérgio P. Camões, Matilde Castro, Joana P. Miranda, Ana S. Fernandes, Nuno G. Oliveira

17:45

5.5 LONG-TERM EXERCISE TRAINING ON MAMMARY CANCER: A NON-PHARMACOLOGICAL APPROACH
Ana I. Faustino-Rocha, Paula A. Oliveira, Adelina Gama, Rita Ferreira, Mário Ginja

18:00

5.6 HORMONE-DEPENDENT BREAST CANCER: THE IMPORTANCE OF AUTOPHAGY AND PI3K FOR AROMATASE INHIBITORS-ACQUIRED RESISTANCE
Tiago V. Augusto, Cristina Amaral, Natércia Teixeira, Georgina Correia-da-Silva

18:15

5.7 SELECTIVE PRO-APOPTOTIC AND ANTIMIGRATORY EFFECT OF CATECHIN: LYSINE COMPLEX (1:2) IN CANCER CELL LINES
C. Silva, A. Correia-Branco, N. Andrade, P. Sonveaux, J. Stephenne and F. Martel

18:30

5.8 NEOPLASTIC TRANSFORMATION OF BREAST EPITHELIAL CELLS INDUCED BY CATECHOLAMINES
Filipa Amaro, D. Silva, C. Quintas, J. Gonçalves, N. Vale, P. Fresco

18:45

Anfiteatro 8

CHAIRS: Cláudia Cavadas and Sílvia Conde

SESSION 6 ENDOCRINE PHARMACOLOGY

6.1 CAROTID SINUS NERVE RESECTION INDUCES BROWNING OF ADIPOSE TISSUE: IMPLICATIONS FOR OBESITY THERAPY
Bernardete F. Melo, Cláudia S. Prego, Joana F. Sacramento, Sílvia V. Conde

6.2 EFFECT OF CAROTID SINUS NERVE DENERVATION ON LONG-TERM HYPERCALORIC DIET EXACERBATION OF AGE-INDUCED METABOLIC DYSFUNCTION: FOCUSING ON THE LIVER
Cláudia C. Batista, Joana F. Sacramento, Bernardete F. Melo, Cláudia S. Prego, Sílvia V. Conde

6.3 SIRTUIN 2 DEFICIENCY TRIGGERS HEPATIC LIPID ACCUMULATION THROUGH ER STRESS-DEPENDENT PATHWAY
João Cardoso, Helena Leal, Vítor Carmona, Janete Cunha-Santos, Luís Pereira de Almeida, Cláudia Pereira, Pedro Gomes, Cláudia Cavadas

6.4 FROM PREDIABETES TO EARLY-STAGE TYPE 2 DIABETES: ROLE OF ADENOSINERGIC SYSTEM ON INSULIN RESISTANCE PROGRESSION IN THE LIVER
Fátima O. Martins, Inês B. Martins, Bernardete F. Melo, Maria J. Ribeiro, Joana F. Sacramento, Sílvia V. Conde

6.5 UNVEILING THE ROLE OF UTERINE OXIDATIVE PROTEIN MODIFICATIONS AS A CONTRIBUTOR TO A DEFECTIVE PLACENTATION
Sara Mendes, Filipa Timóteo-Ferreira, Adriana Raquel Rodrigues, Liliãna Matos, Joaquim Saraiva, Henrique Almeida, Luís Guedes-Martins, Elisabete Silva

6.6 A NEUROENDOCRINE STRATEGY TO DELAY AGING OF HUTCHINSON-GILFORD PROGERIA SYNDROME
Marisa Ferreira-Marques, André Carvalho, Sara Carmo-Silva, Mariana Botelho, Cláudia Cavadas, Célia Aveleira

6.7 GENDER-SPECIFICITIES OF ANTENATAL GLUCOCORTICOID EXPOSURE: FOCUS ON THE PERIPHERAL METABOLISM AND GLUCOSE HOMEOSTASIS
Ana Sofia Ferreira, Sofia Galvão, Inês Ventura, Rita Gaspar, A. Catarina Rodrigues-Neves, Paulo Matzafome, Carlos A. Fontes-Ribeiro, António F. Ambrósio, Catarina A. Gomes, Filipa I. Baptista

6.8 THE CONTRIBUTION OF THE CAROTID BODY TO LEPTIN EFFECTS ON VENTILATION, ARTERIAL PRESSURE AND SYMPATHETIC ACTIVITY IN AN OBESE MODEL
Maria J. Ribeiro, João P. Guimarães, Sílvia V. Conde

19:15

Business Council Meeting

09:00 **FREE ORAL COMMUNICATIONS**

Salão Nobre ICBAS/FFUP

CHAIRS: Maria J. Diógenes and Glória Queiroz

SESSION 7 NEUROPHARMACOLOGY II

09:00

7.1 IMPACT OF AMYLOID- β PEPTIDES ON ASTROCYTIC GLIOTRANSMITTERS RELEASE: MODULATION BY ADENOSINE A_{2A} RECEPTORS

Daniela Madeira, Liliana Dias, Patrícia Santos, Paula M. Canas, Rodrigo A. Cunha, Paula Agostinho

09:15

7.2 IMPAIRED SYNAPTIC PLASTICITY AND COGNITIVE PERFORMANCE IN OBESE AGED RATS

Sara L. Paulo, Catarina Miranda-Lourenço, Rita Belo, Rui S. Rodrigues, Sara R. Tanqueiro, João Fonseca-Gomes, Nataniel Gonçalves-Rosa, Catarina Nunes-da-Silva, Ana M. Sebastião, Sara Xapelli, Maria J. Diógenes

09:30

7.3 THE EFFECT OF THE NON-PSYCHOACTIVE CANNABINOID CANNABIDIVARIN AND TRPV1 AGONIST CAPSAICIN ON NEURAL STEM CELL PROLIFERATION AND DIFFERENTIATION

Diogo M. Lourenço, R. Soares, Rui S. Rodrigues, A. M. Sebastião, S. Xapelli

09:45

7.4 ENDOPLASMIC RETICULUM AND MITOCHONDRIAL STRESS RESPONSES IN NEURONAL CELLS IN THE CONTEXT OF ALZHEIMER'S DISEASE

Fábio Sousa, Paula Moreira, Armanda Santos, Henrique Girão, Maria Teresa Cruz, Cláudia Pereira

10:00

7.5 HUNTINGTIN PROTEOSTASIS AND MITOCHONDRIAL FUNCTION PREDICT DIFFERENTIAL NEURONAL VULNERABILITY IN HUNTINGTON'S DISEASE

Tânia R. Soares, Brígida R. Pinho, Michael R. Duchon, Jorge M. A. Oliveira

10:15

7.6 INVOLVEMENT OF ADENOSINE A_{2A} RECEPTORS IN ASTROCYTIC CA_{2+} DYNAMICS IN ALZHEIMER'S DISEASE-LIKE CONDITIONS

Liliana Dias, Daniela Madeira, Ângelo R. Tomé, Rodrigo A. Cunha, Paula Agostinho

10:30

7.7 GABA AND GLUTAMATE RELEASE IS DIFFERENTIALLY AFFECTED BY METHYLPREDNISOLONE IN ISOLATED NERVE TERMINALS OF THE RAT HIPPOCAMPUS

Rafael Neiva, M. Graça Lobo & Paulo Correia-de-Sá

10:45

Anfiteatro 8

CHAIRS: Maria Lourdes Bastos and Fernando Remião

SESSION 8 TOXICOLOGY II

8.1 SYNTHETIC CANNABINOIDS 5F-PB22 AND THJ-2201 PROMOTE NEURONAL DIFFERENTIATION IN NEUROBLASTOMA CELLS AT IN VIVO RELEVANT CONCENTRATIONS

João Alexandre, Rui Malheiro, Helena Carmo, Félix Carvalho, João P. Silva

8.2 EFFECTS OF BLACK-EYE-BEAN (VIGNA UNGUICULATA) DIET SUPPLEMENTATION IN HEALTHY ANIMALS

Paula. A. Oliveira, Bruno Mendes, Rita Reis, Tiago Ferreira, Carlos Venâncio^{2,3}, L. Félix, Maria J. Pires, Adelina Gama^{1,4}, Isabel Gaivão, Eduardo Rosa

8.3 α -AMANITIN CYTOTOXICITY IN HEPG2 CELLS AND EVALUATION OF PUTATIVE ANTIDOTES

Daniela Ferreira Rodrigues, Vera Marisa Costa, Maria Lourdes Bastos, Félix Carvalho

8.4 IMMUNOTOXICITY PROFILE OF PLA NANOPARTICLES

Jessica Da Silva, Sandra Jesus, Natália Bernard, Olga Borges

8.5 IN VITRO EVALUATION OF THE PHOTOTOXICITY OF NATURAL PHENOLIC ANTIOXIDANTS

Brandon Aguiar, Helena Carmo, Jorge Garrido, J.M. Sousa Lobo, Isabel F. Almeida

8.6 EVALUATION OF IMMUNOTOXICOLOGICAL PROPERTIES IN NANOPARTICLES: PCL AND PCL/GLUCAN

Natalia Bernardi, Sandra Jesus, Jessica Da Silva, Olga Borges

8.7 IMMUNOTOXICOLOGICAL EVALUATION OF CHITOSAN NANOPARTICLES

Alana Duarte, Ana Patrícia Marques, Sandra Jesus, Mariana Colaço, Olga Borges

8.8 THIOREDOXIN REDUCTASE INHIBITORS AS POTENTIAL ANTITUMORALS: MERCURY COMPOUNDS EFFICACY IN TWO DIFFERENT GLIOMA CELLS

Isabella Calvo Bramatti, Vanessa Pires, Vasco Branco, Cristina Carvalho

11:00 **Coffee Break**

11:15 | **FREE ORAL COMMUNICATIONS**

Salão Nobre ICBAS/FFUP
CHAIRS: Joana Miranda and Frederico Pereira

**SESSION 9 MOLECULAR & CELLULAR
 BASED THERAPIES II**

11:15 **9.1 *IN VITRO* MODULATION OF P-GLYCOPROTEIN BY XANTHONIC DERIVATES: IMPLICATIONS ON ALZHEIMER'S DISEASE**
Eva Martins, Daniel J. Barbosa, Emília Sousa, Diana Resende, Madalena Pinto, Fernando Remião, Renata Silva

11:30 **9.2 THERAPEUTIC POTENTIAL OF NTPDASE3 INHIBITION TO REHABILITATE THE OSTEOGENIC COMMITMENT OF BONE MARROW MESENCHYMAL STEM CELLS FROM POSTMENOPAUSAL WOMEN**
Rui Cardoso, Maria T. Magalhães-Cardoso, Isabel Calejo, Isabel Silva, Fátima Ferreirinha, Maria Adelina Costa, José Marinhas, Rolando Freitas, Julie Pelletier, Jean Sévigny, José Bernardo Noronha-Matos, Paulo Correia-de-Sá

11:45 **9.3 CYP46A1 OVEREXPRESSION ALLEVIATES MACHADO-JOSEPH DISEASE**
Clévio Nóbrega, Liliana S. Mendonça, Adriana Marcelo, Antonin Lamazière, Sandra Tomé, Gaëtan Déspres, Carlos Matos, Fatic Mechmet, Dominique Langui, Wilfred den Dunnen, Luís Pereira de Almeida, Nathalie Cartier, Sandro Alves

12:00 **9.4 THE SECRETOME OF 3D-CULTURED MSCS ALLEVIATES EXPERIMENTAL RHEUMATOID ARTHRITIS SYMPTOMS**
Sérgio P Camões, Manuela M Gaspar, Joana S Rodrigues, Manuela Carvalheiro, Sandra Simões, Jorge M Santos, Joana P Miranda

12:15 **9.5 EFFECTS OF ANTIOXIDANT SUPPLEMENTATION IN OVARIAN AGEING**
F. Timóteo-Ferreira, N.A. Rocha, S. Mendes, A.R. Rodrigues, L. Matos, H. Almeida, E. Silva

12:30 **9.6 STUDYING HEPATOCYTE-LIKE CELLS IN MICROFLUIDIC DEVICES: A NEW TOOL FOR DRUG DISCOVERY, TOXICOLOGY AND DISEASE MODELLING**
Joana S. Rodrigues, Madalena Cipriano, Jorge C. Correia, Sérgio P. Camões, Matilde Castro, Jorge L. Ruas, Joana P. Miranda

12:45 **9.7 XANTHONES AS POTENTIAL P-GLYCOPROTEIN MODULATORS: *IN VITRO* AND *EX VIVO* STUDIES**
Vera Silva, Renata Silva, Eva Martins, Emília Sousa, Diana Resende, Madalena Pinto, Fernando Remião, Carolina Rocha-Pereira

Anfiteatro 8
CHAIRS: Maria Augusta V. Coelho and Alexandrina Mendes

**SESSION 10 INFECTION /INFLAMMATION
 / IMMUNITY**

10.1 INTRACELLULAR ADENOSINE RELEASED FROM LEISHMANIA INFECTED MACROPHAGES IS INVOLVED IN AN AUTOCRINE CONTROL OF MACROPHAGE RESPONSE, THROUGH A2 ADENOSINE RECEPTORS ACTIVATION
Dany Silva, D. Moreira, A. Cordeiro-da-Silva, J. Gonçalves, P. Fresco

10.2 HUMAN CHONDROCYTES ARE TARGETED BY NEUROPEPTIDE Y: IMPLICATIONS IN OSTEOARTHRITIS
Inês Ferreira, Caren Rodrigues, Cátia Sousa, Soraia Silva, Fernando Judas, Cláudia Cavadas, Alexandrina Ferreira Mendes

10.3 NOVEL COMBINATIONS OF ANTHELMINTIC/ANTIOXIDANT AGAINST SCHISTOSOMA MANSONI
Maria João Gouveia, Paul Brindley, Gabriel Rinaldi, Fátima Gärtner, José Manuel Correia da Costa, Nuno Vale

10.4 ROLE OF ENDOPLASMIC RETICULUM-MITOCHONDRIA CONTACTS IN INFLAMASSOME ACTIVATION DURING CELLULAR STRESS CONDITIONS
Ana Catarina Pereira, Isabel Ferreira, Bruno Neves, Sofia Morais Nuno Madeira, Vítor Santos, António Macedo, Maria Teresa Cruz, Cláudia Pereira

10.5 ENDOTOXIN-FREE CHITOSAN DOES NOT STIMULATE HUMAN PBMCS PROINFLAMMATORY CYTOKINE SECRETION
João Panão da Costa, Edna Soares, Olga Borges

10.6 HUMAN FIBROBLASTS DIFFERENTIATION AND COLLAGEN DEPOSITION INDUCED BY TGF-β IS REVERTED BY AM630, A SELECTIVE CB2 ANTAGONIST
Inês Correia-Sá, Vera A. Machado, Sofia Carvalho, Paula Serrão, Maria A. Vieira-Coelho

10.7 CURCUMIN-LOADED GLUCAN NANOPARTICLES: IMMUNOTOXICITY PROFILE
Mariana Colaço, Ana Patrícia Marques, Sandra Jesus, Olga Borges

13:00 | **Lunch** (for registered participants only)

Salão Nobre ICBAS/FFUP
CHAIR: Félix Carvalho

14:00 | **INDUSTRY SPONSORED SESSION**

CHRONIC TOXICITY AND LUNG TUMORIGENESIS IN A/J MICE FOLLOWING LIFETIME EXPOSURE TO AEROSOL FROM THE TOBACCO HEATING SYSTEM (THS) 2.2 IN COMPARISON TO EXPOSURE TO 3R4F REFERENCE CIGARETTE SMOKE, SPEAKER: KARSTA LUETTICH

15:00 | **FREE ORAL COMMUNICATIONS**

Salão Nobre ICBAS/FFUP
Chairs: Ana Sebastião and Rodrigo Cunha

SESSION 11 NEUROPHARMACOLOGY III

Anfiteatro 8
Chairs: Lucília Saraiva and Nuno Oliveira

SESSION 12 CANCER PHARMACOLOGY II

15:00 **11.1 CONTROL OF SYNAPTIC PLASTICITY AND OF NMDA RECEPTOR FUNCTION BY ADENOSINE A_{2A} RECEPTORS IN THE AMYGDALA**
 Anna Pliássova, Samira G. Ferreira, Margarida Henriques, Henrique B. Silva, Inês Marques-Morgado, Luísa V. Lopes, Paula Agostinho, Rodrigo A. Cunha

12.1 TARGETING ANDROGEN RECEPTOR (AR) IMPROVE BREAST CANCER TREATMENT WITH EXEMESTANE
Cristina Amaral, Tiago Augusto, Marta Almada, Georgina Correia-da-Siva, Natércia Teixeira

15:15 **11.2 THE ROLE OF ASTROCYTIC GABA TRANSPORTER 1 IN CHILDHOOD ABSENCE EPILEPSY MODELS**
 Carolina Pina, Tatiana P. Morais, Vincenzo Crunelli, Ana M. Sebastião, Sandra H. Vaz

12.2 DELPHINIDIN-3-O-GLUCOSIDE INHIBITS ANGIOGENESIS AND MIGRATION IN TRIPLE NEAGTIVE BREAST CANCER CELLS
 Olga Viegas, Miguel A. Faria, Joana B. Sousa, Martin Vojtek, Salomé Gonçalves-Monteiro, Joanna Suliburska, Carmen Diniz, Isabel M.P.L.V.O. Ferreira

15:30 **11.3 IN VIVO EFFECTS OF THE MITOCHONDRIA-TARGETED ANTIOXIDANT MITOQ IN A MOUSE MODEL OF HUNTINGTON'S DISEASE**
 Brígida R. Pinho, Ana I. Duarte, Líliliana M. Almeida, Paula M. Canas, Paula I. Moreira, Mike P. Murphy, Jorge M. A. Oliveira

12.3 MANIO: A NEW POTENTIAL ANTICANCER DRUG CANDIDATE BY TARGETING P53
 Helena Ramos, Joana Soares, Líliliana Raimundo¹, Rute Pinheiro, Maria Isabel Soares, Célia Gomes, Flávio Reis, Alberto Inga, Teresa M.V.D. Pinho e Melo, Lucília Saraiva

15:45 **11.4 ASTROCYTIC CB1R INCREASES GLAST ACTIVITY**
 Joana Ribeiro, Tatiana P. Morais, Oksana Savchak, Carlos Meneses, Ana M. Sebastião, Sandra H. Vaz

12.4 STUDY OF NEW THERAPEUTIC STRATEGIES TO COMBAT BREAST CANCER
Ana Correia, D. Silva, A. Correia, M. Vilanova, F. Gartner, N. Vale

16:00 **11.5 THE SHORT- AND LONG-TERM EFFECTS OF CHRONIC ADOLESCENT EXPOSURE TO HU-210 ON DEPRESSIVE-LIKE PHENOTYPES**
 Miguel F. Ferreira, João Fonseca-Gomes, Nádia Rei, Sandra H. Vaz, Valéria Martins, Beatriz Pereira, Francisco M. Mouro, Ana M. Sebastião

12.5 DEVELOPMENT OF NEW METHOTREXATE CONJUGATES FOR CANCER THERAPY
 Vitor Yang, Sílvia Santos Pedrosa, Rita Fernandes, Diana Duarte, Ana Colette Maurício, Beate Koksche, Fátima Gärtner, Irina Amorim, Nuno Vale

16:15 **11.6 ADENOSINE A_{2A} RECEPTORS MODULATE THE EXTINCTION OF FEAR MEMORIES**
 Sara L. Reis, Vanessa Lourenço, Rodrigo A. Cunha, Paula M. Canas, Ana Patrícia Simões

12.6 PARECOXIB EFFECTS IN THE MG-63 CANCER CELL LINE
 Sílvia Lemos, Isabel Gaivão, Carlos Palmeira, Gabriela Martins, Francisco Peixoto, Paula A. Oliveira, Rosário Pinto-Leite

16:30 **11.7 GLIOTRANSMISSION ROLE UPON AMYLOID-β MEDIATED EXCITOTOXICITY** Joana Gomes, João Fonseca-Gomes, Hugo Vicente Miranda, Ana M. Sebastião, Maria J. Diógenes, Sandra H. Vaz

12.7 IMPROVING COLON CANCER THERAPY USING A NOVEL P53-ACTIVATING AGENT
 Líliliana Raimundo, Margarida Espadinha, Joana Soares, Joana B Loureiro, Marco G Alves, Maria M M Santos, Lucília Saraiva

16:45 **11.8 CIRCULATING EXTRACELLULAR VESICLES IN METHAMPHETAMINE- INTOXICATED MICE SUBJECTED TO CHRONIC AEROBIC PHYSICAL EXERCISE**
 Mariana Rodrigues, Julie Reis, Inês Pita, Sofia D. Viana, Mónica Zuzarte, Tânia Martins-Marques, Teresa Ribeiro-Rodrigues, Henrique Girão, Carlos A. Fontes-Ribeiro, Aderbal S. Aguiar Jr, Frederico C. Pereira

12.8 INCREASING THE POTENTIAL OF CELL-PENETRATING PEPTIDES FOR CANCER THERAPY USING A NEW PENTAGONAL SCAFFOLD
 Diana Duarte, F. Martel, N. Vale

17:00 | **Coffee Break**

17:15 | **FREE ORAL COMMUNICATIONS**

Salão Nobre ICBAS/FFUP

CHAIRS: Emília C. Monteiro and Francisco Batel Marques

SESSION 13 CLINICAL PHARMACOLOGY I

Anfiteatro 8

CHAIRS: Manuela Morato and Flávio Reis

**SESSION 14 GASTROINTESTINAL/RENAL/
PULMONAR PHARMACOLOGY**

17:15

13.1 INTENSIVE DRUG SAFETY MONITORING PROGRAM: RESULTS OF A PILOT STUDY IN A PORTUGUESE ONCOLOGY HOSPITAL

Diogo Mendes, Graça Rigueiro, Rui Sousa Silva, Ana Penedones, Carlos Alves, Gabriela Sousa Francisco Batel Marques

14.1 EFFECTS OF INCRETIN-BASED THERAPIES ON THE GASTROINTESTINAL MOTILITY OF AN ANIMAL MODEL OF MULTIPLE SCLEROSIS

Beatriz Martins, Andreia Melo, Carlota Nóbrega, Sara Nunes, Filipe Palavra, Rosa Fernandes, Carlos Fontes-Ribeiro, Sofia Viana, Flávio Reis, Sónia Silva

17:30

13.2 PHOSPHODIESTERASE TYPE 5 INHIBITORS AND NON-ARTERITIC ANTERIOR ISCHAEMIC OPTIC NEUROPATHY: A SYSTEMATIC REVIEW OF CASE REPORTS

Ana Penedones, Francisco Batel Marques

14.2 URINARY MERCAPTURATES OF CYSTEINE-DISULFIDES DECREASE IN MODELS OF DRUG-INDUCED ACUTE KIDNEY INJURY

Clara Gonçalves-Dias, Karina Soto Sandra M. Sancho-Martinez, M. João Correia, Nuno R. Coelho, Marta Prieto-Vicente, Emília C. Monteiro, Francisco J. López-Hernández, Sofia A. Pereira

17:45

13.3 TRANSPARENCY AND ACCURACY IN FUNDING INVESTIGATOR-INITIATED CLINICAL TRIALS: A SYSTEMATIC SEARCH IN CLINICAL TRIALS DATABASES

Catarina Madeira, Francisco dos Santos, Joana R. Batuca, Emília C. Monteiro

14.3 β 3 ADRENOCEPTOR INHIBITION OF CHOLINERGIC NEUROTRANSMISSION INVOLVES ADENOSINE OUTFLOW VIA THE EPAC/PKC/ENT1 PATHWAY IN THE URINARY BLADDER

Isabel Silva, M Teresa Magalhães Cardoso, Fátima Ferreirinha, Ana Filipa Costa, Sílvia Moreira, Diogo Silva, Miguel Silva-Ramos, Paulo Correia-de-Sá

18:00

13.4 ARE PATIENTS TREATED WITH IVABRADINE AT HIGHER RISK OF NEW ONSET ATRIAL FIBRILLATION?

Cristina Saldanha, James Milner, Vera Marinho, Pedro Sousa, Miguel Ventura, João Cristóvão, Luis Elvas, Carlos Fontes Ribeiro, Lino Gonçalves, Natália António

14.4 MECHANISMS OF COLONIC ANGIOTENSIN II-MEDIATED CONTRACTION IN AN EXPERIMENTAL MODEL OF INFLAMMATORY BOWEL DISEASE

Mariana Ferreira-Duarte, Fernando Magro, Margarida Duarte-Araújo, Manuela Morato

18:15

13.5 CLINICAL RESEARCH CENTRES CONDUCTING NON-COMMERCIAL TRIALS IN PORTUGAL: A SYSTEMATIC REVIEW IN INTERNATIONAL REGISTRIES

Daniela Matias, Maria Andrade, Catarina Madeira, Afonso Cavaco, Emília C. Monteiro, Joana R. Batuca

14.5 GUT BARRIER INTEGRITY, SERUM INFLAMMATION AND LIVER DAMAGE IN A RAT MODEL OF PREDIABETES INDUCED BY HYPERCALORIC DIET - EFFECTS OF BLUEBERRY JUICE TREATMENT

Sara Nunes, Sofia D. Viana, Ana Castela, Rosa Fernandes, Anabela P. Rolo, Carlos M. Palmeira, Cláudia Cavadas, Maria M. Pintado, Flávio Reis

18:30

13.6 A SYSTEMATIC REVIEW OF ECONOMIC STUDIES EVALUATING OPHTHALMIC DRUGS: AN ANALYSIS OF THE EFFECTIVENESS OUTCOMES

Inês Ribeiro, Francisco Batel Marques, Carlos Alves

14.6 WISTAR: HAN SUPPLIER DIFFERENCES IN THE MONOCROTALINE MODEL OF PULMONARY ARTERIAL HYPERTENSION (PAH)

Vânia L. Batalha, Eduardo Moura, Cristina Costa, Filipa Sousa, Maria-João Bonifácio, Patrício Soares-da-Silva

18:45

13.7 OCCURENCE OF ISCHEMIC STROKE DESPITE DOAC USE IN NON-VALVULAR AF PATIENTS: DOSING REGIMEN MATTERS

Joana Santos, James Milner, Ana Vera Marinho, Cátia Ferreira, Luis Fernandes, João Sargento Freitas, Lino Gonçalves, Luis Cunha, Natália António

14.7 LOSS OF FUNCTION OF THE UTP-SENSITIVE P2Y11 RECEPTOR CONTRIBUTES TO RIGHT VENTRICLE REMODELLING SECONDARY TO CARDIAC PRESSURE OVERLOAD IN PULMONARY HYPERTENSION

L. Azevedo-Araújo, C. Herman-de-Sousa, E. Dias, M.A. Costa, P. Correia-de-Sá, A.P. Fontes-Sousa

19:00

13.8 FLUOROQUINOLONES USE AND RISK OF TENDINOPATHY: A META-ANALYSIS

Carlos Alves, Diogo Mendes, Francisco Batel Marques

14.8 INVESTIGATION OF URINARY VOLATILE METABOLITES AS POTENTIAL PROSTATE CANCER BIOMARKERS BY HEADSPACE SOLID-PHASE MICROEXTRACTION IN COMBINATION WITH GAS CHROMATOGRAPHY-MASS SPECTROMETRY

Ana Rita Lima, Ana Isabel Azevedo, Joana Pinto, Carmen Jerónimo, Rui Henrique, Maria de Lourdes Bastos, Márcia Carvalho, Paula Guedes de Pinho

20:30 | **Social Dinner** (for registered participants only)

10:00 | FREE ORAL COMMUNICATIONS

Salão Nobre ICBAS/FFUP

CHAIRS: Clara Quintas and Paulo Correia de Sá

SESSION 15 NEUROPHARMACOLOGY IV

10:00

15.1 UNRAVELLING THE MECHANISMS BEHIND MICROGLIA CONTROL OF PURINERGIC-MEDIATED ASTROGLIAL PROLIFERATION

Rui Silva, Clara Quintas, Jorge Gonçalves, Glória Queiroz

10:15

15.2 EFFECT OF NEUROPEPTIDE S ON SYNAPTIC TRANSMISSION AND PLASTICITY IN RAT HIPPOCAMPAL SLICES

Lisiane de S. Souza, Henrique B. Silva, Pablo Pandolfo, Alexandre dos Santos Rodrigues, Rodrigo A. Cunha

10:30

15.3 MUTANT ATAXIN-3 SPREADING IN MACHADO-JOSEPH DISEASE

Liliana S. Mendonça, Ricardo Moreira, Daniel Henriques, Sónia Duarte, Teresa Rodrigues, Henrique Girão, Jens C. Schwamborn, Luis Pereira de Almeida

10:45

15.4 PHARMACOLOGICAL ACTIVATION OR BLOCKADE OF A_{2A} ADENOSINE RECEPTORS MODULATES CONTEXTUAL FEAR MEMORY CONSOLIDATION AND GENERALIZED FEAR EXPRESSION IN MALE WISTAR RATS

Marina A. Magnini Portes, Rodrigo A. Cunha, Rui D. S. Prediger

11:00

15.5 ATP AND ADENOSINE ARE INVOLVED IN CB OVERACTIVATION IN HIGH FAT DIET RATS: POTENTIAL THERAPEUTIC FOR TYPE 2 DIABETES

Joana F. Sacramento, João P. Cunha-Guimarães, Cláudia S. Prego, Carla Quintão, Sílvia V. Conde

Anfiteatro 8

CHAIRS: Helena Carmo and João Capela

SESSION 16 TOXICOLOGY III

16.1 PENTEDRONE AND METHYLONE ENANTIOSELECTIVITY IN DIFFERENTIATED SH-SY5Y CELLS

Bárbara Silva, José A. Pereira, Carla Fernandes, Madalena Pinto, Paula Guedes de Pinho, Fernando Remião

16.2 SUB-CHRONIC EXPOSURE TO THERAPEUTIC DOSES OF TRAMADOL AND TAPENTADOL CAUSES HEPATOTOXICITY IN WISTAR RATS

Joana Barbosa, Juliana Faria, Sandra Leal, Vanessa Nascimento, Luís Pedro Afonso, Odília Queirós, Roxana Moreira, Frederico Pereira, Félix Carvalho, Ricardo Jorge Dinis-Oliveira

16.3 TARGETING PHENOLIC DIETARY ANTIOXIDANTS TO MITOCHONDRIA TO MODULATE REDOX SIGNALING AND METABOLISM

André Barbosa, Ricardo Amorim, Caroline Velloso¹, Sofia Benfeito², Catarina Oliveira, Fernanda Borges, Paulo J. Oliveira, José Teixeira

16.4 TETRAHYDROCANNABINOL DISRUPTS ESTROGEN SIGNALING IN HUMAN PLACENTA

João Maia, Marta Almada, Luís Midão, Bruno Fonseca, Jorge Braga, Daniela Gonçalves, Natércia Teixeira, Georgina Correia-da-Silva

16.5 THE EFFECT OF PHARMACEUTICALS AND PERSONAL CARE PRODUCTS IN DRINKING WATER BACTERIAL BEHAVIOR

Inês Gomes, Lúcia Simões, Manuel Simões

11:15 | Coffee Break

11:30 | FREE ORAL COMMUNICATIONS

Salão nobre ICBAS/FFUP

CHAIRS: Luisa V. Lopes and Paula Agostinho

SESSION 17 NEUROPHARMACOLOGY V

11:30

17.1 ADENOSINE A_{2A} RECEPTORS IN THE BASOLATERAL AMYGDALA MODULATE FEAR EXTINCTION

Sara Reis, Vanessa Lourenço, Rodrigo A. Cunha Paula M. Canas, Ana Patrícia Simões

11:45

17.2 DISRUPTION OF BLOOD-BRAIN BARRIER IN MACHADO-JOSEPH DISEASE

Diana Lobo, Rui Jorge Nobre, Catarina Oliveira Miranda, Dina Pereira, João Castelhamo, José Sereno, Miguel Castelo-Branco, Luis Pereira de Almeida

12:00

17.3 ROLE OF CANNABINOID TYPE 2 RECEPTOR AND PHYSICAL EXERCISE IN SUBVENTRICULAR ZONE NEUROGENESIS

João B. Moreira, Rui S. Rodrigues, Diogo M. Lourenço, Ana M. Sebastião, Sara Xapelli

12:15

17.4 GLUCOCORTICOID FETAL PROGRAMMING: A COMPARATIVE STUDY BETWEEN DEXAMETHASONE AND BETAMETHASONE

Inês Ventura, Sofia Ferreira, Sofia Galvão, Ana C. Rodrigues-Neves, Rita Gaspar, Carlos A. Fontes-Ribeiro, António F. Ambrósio, Filipa I. Baptista, Catarina A. Gomes

12:30

17.5 INCREASED ADENOSINE CONCENTRATIONS ARE ASSOCIATED DECREASED HEARING ABILITY IN CHRONIC OTITIS MEDIA WITH EFFUSION

Inês B. Martins, Sílvia V. Conde, Sara Baptista, António Larroude, Paulo Vera-Cruz

Anfiteatro 8

CHAIRS: João P. Teixeira and Ricardo Dinis

SESSION 18 TOXICOLOGY IV

18.1 MITOCHONDRIOTROPIC ANTIOXIDANTS BASED ON DIETARY HYDROXYCINNAMIC ACIDS AS AN ATTEMPT TO REDUCE SKIN AGING

Caroline Velloso, Fernando Cagide, Sofia Benfeito, Fernanda Borges, Paulo J. Oliveira, José Teixeira

18.2 RAT PROSTATE CANCER MODEL: ANTHROPOMETRIC DATA AND LESIONS IDENTIFIED ON DORSOLATERAL PROSTATE

Elisabete Gonçalves, Fernanda Seixas, Bruno Colaço, Rita Ferreira, Paula A. Oliveira

18.3 NOVEL PSYCHOACTIVE BENZOFURANS: COMPARISON OF THE TOXICITY ELICITED BY THE ISOMERS 5-APB AND 6-APB IN THREE VITRO HEPATOCYTE MODELS

Rita Roque Bravo, Félix Carvalho, Maria de Lourdes Bastos, Helena Carmo, Diana Dias da Silva

18.4 FULL SURVIVAL OF A-AMANITIN-EXPOSED MICE AFTER TREATMENT WITH POLYMYXIN B AND METHYLPREDNISOLONE

Juliana Garcia, Vera Marisa Costa, Antonio Bovolini, José Alberto Duarte, Daniela Ferreira Rodrigues, Maria de Lourdes Bastos, Félix Carvalho

18.5 THE PSYCHOSTIMULANT 3-METHYLMETHCATHINONE (3-MMC) ELICITS AUTOPHAGY AND APOPTOSIS IN PRIMARY RAT HEPATOCYTES

Tomás Duarte de Almeida, Maria João Valente, Bárbara Ferreira, Rita Rebelo, Rita Roque, Félix Carvalho, Maria de Lourdes Bastos, Helena Carmo, Diana Dias da Silva

12:45 | **Lunch** (free to all participants)

13:45 | **FREE ORAL COMMUNICATIONS**

Salão Nobre ICBAS/FFUP

CHAIRS: Sofia Pereira and Ana Rita Álvaro

SESSION 19 CLINICAL PHARMACOLOGY II

19.1 USING PARACETAMOL AS A PROBE TO ASSESS INTRAAINDIVIDUAL VARIABILITY AND SEX-DEPENDENT DIFFERENCES ON SULT ACTIVITY

Natália Marto, Judit Morello, Alexandra MM Antunes, Emília C Monteiro, Sofia A Pereira

19.2 THE SCIENTIFIC IMPACT OF INVESTIGATOR-INITIATED CLINICAL TRIALS IN PORTUGUESE INSTITUTIONS: A SYSTEMATIC SEARCH IN CLINICAL TRIALS DATABASES

Maria Andrade, Daniela Matias, Joana Batuca, Helder Mota-Filipe, Emília C. Monteiro, Catarina Madeira

19.3 NEUROCHEMICAL MECHANISMS OF ANTIPSYCHOTICS: REGARDING A CLINICAL CASE

João Quarenta, Teresa Ferreira

19.4 EFFECTIVENESS OF AN INTERVENTION TO IMPROVE ANTIBIOTIC USE: RANDOMIZED CONTROLLED CLUSTER TRIAL

Maria Teresa Herdeiro, António Teixeira Rodrigues, Luiza Breitenfeld, Amílcar Falcão, Adolfo Figueiras, Fátima Roque

19.5 EVALUATION OF HALLMARKS OF CELLULAR AGING AS BIOMARKERS OF OBSTRUCTIVE SLEEP APNEA

Laetitia Gaspar, Bárbara Santos, Sara Carmo-Silva, Joaquim Moita, Cláudia Cavadas, Ana Rita Álvaro

19.6 A FOCUS GROUP STUDY TO EXPLORE HEALTH PROFESSIONALS PERCEPTIONS ABOUT DRUG RELATED PROBLEMS IN THE ELDERLY - PROJECT MEDELDERLY PART I

Fátima Roque, Ana Isabel Plácido, Maria Teresa Herdeiro

19.7 PATIENTS' CLINICAL INFORMATION REQUIREMENTS AND STOPP/START CRITERIA APPLICABILITY – A STUDY IN NURSING HOME RESIDENTS

Rosário Carvalho, Marta Lavrador, Ana Cabral, Manuel Teixeira Veríssimo, Fernando Fernandez-Llimos, Isabel Vitória Figueiredo, Maria Margarida Castel-Branco

19.8 CHARACTERIZATION OF A TRIAL-READY PORTUGUESE COHORT OF MACHADO-JOSEPH DISEASE PATIENTS: STATUS UPDATE

Patrick Silva, Magda M. Santana, Joana Ribeiro, Inês Cunha, Laetitia Gaspar, Cristina Januário, Luís Pereira de Almeida and ESMI consortium

Anfiteatro 8

CHAIRS: Patrício Soares da Silva and Gilberto Alves

SESSION 20 PHARMACOKINETICS

20.1 INTRODUCTION TO GASTROPLUSTM FOR PBPK MODELLING AND STUDY THE CLINICAL SIMULATION OF ANTIBIOTICS

Abigail Ferreira, Helena Martins, José Carlos Oliveira, Rui Lapa, Nuno Vale

20.2 EXTENT OF BRAIN EXPOSURE OF CATECHOL-O-METHYLTRANSFERASE INHIBITORS: IN VIVO PHARMACOKINETIC STUDIES

Joana Bicker, Ana Fortuna, Sofia Sousa, Gilberto Alves, Patrício Soares-da-Silva, Amílcar Falcão

20.3 IN-VIVO SELECTIVITY PROFILING OF BIA 10-2474 AGAINST SERINE HYDROLASES IN THE RAT BRAIN

Maria-João Bonifácio, Paul Moser, Patrício Soares-da-Silva

20.4 INDIVIDUALIZING PHARMACOTHERAPY OF LEVETIRACETAM: PREDICTIVE PERFORMANCE OF THREE PHARMACOKINETIC MODELS

Rui Silva, Anabela Almeida, Joana Bicker, Joana Gonçalves, Francisco Sales, Ana Silva, Amílcar Falcão, Ana Fortuna

20.5 COMPUTATIONAL MODELLING OF THE ANTICONSULSANT ACTIVITY IN THE SUBCUTANEOUS PENTYLENETETRAZOLE SEIZURE MODEL

Gonçalo Campos, Amílcar Falcão, Gilberto Alves

20.6 INTRANASAL ADMINISTRATION OF LEVETIRACETAM IN MICE: IS IT A PROMISING NOSE-TO-BRAIN STRATEGY?

Joana Gonçalves, Joana Bicker, Filipa Gouveia, Gilberto Alves, Amílcar Falcão, Ana Fortuna

20.7 NOVEL COST-EFFECTIVE ICP-MS METHOD FOR PHARMACO-TOXICOKINETIC STUDIES OF PLATINUM AND PALLADIUM-BASED DRUGS IN ANIMAL TISSUES

Martin Vojtek, Edgar Pinto, Salomé Gonçalves-Monteiro, Agostinho Almeida, Isabel M.P.L.V.O. Ferreira, Carmen Diniz

20.8 DEVELOPMENT AND VALIDATION OF THE FIRST HPLC-DAD METHOD FOR RUFINAMIDE QUANTIFICATION IN MOUSE PLASMA AND TISSUES WITH FOCUS ON FUTURE PHARMACOKINETIC STUDIES

Sara Meirinho, Márcio Rodrigues, Ana Fortuna, Amílcar Falcão, Gilberto Alves

16:00 | **Closing Session**

